

INUKTUN VT150 VERTICAL CRAWLER

OnDemand Specialty System



ADJUST TO SIZE. POWER TO SPARE.

Eddyfi Technologies' Inuktun VT150 Vertical Crawler™ is a unique solution for asset integrity condition assessments of those seemingly inaccessible industrial locations.

Industries & Applications

- Oil and Gas (Offshore/Onshore)
- Petrochemical
- Nuclear
- Mining

Familiar and proven technology

The big brother to Eddyfi Technologies' Inuktun VT100 Vertical Crawler™, the Inuktun VT150 Vertical Crawler™ employs familiar and proven Inuktun Minitracs™ and an Inuktun Spectrum 90™ pan, tilt and zoom camera. The vehicle operates in pipe ranges from 406 to 914 millimetres (16 to 36 inches)***, easily adapting to its environment with a remote pipe adjusting chassis. Intuitive functions for vehicle and camera control allow inspectors to quickly learn and operate this powerful system.

Support for nondestructive testing sensors and tooling is readily available to capture specific data requirements for custom projects. Ideal for flexible risers, vertical and inclined pipework and caissons, vertical air and seawater intakes, oil and gas refineries, water and sewer pipelines, the VT150VC is a unique solution for asset integrity condition assessments of those seemingly inaccessible industrial locations. Special versions have included a rotation drive for precision radial positioning, and bidirectional shuttle for multi-tool deployment. Bring us your unique requirements!



SPECIFICATIONS

KEY SPECIFICATIONS

Depth Rating	60 m (200 ft)
Maximum Tether Length	900 m (3,000 ft)* depending on system configuration and operation
Maximum Speed	6.4 m (20.9 ft) per minute
Vehicle Payload	11 kg (25 lb) per track
Front Facing Camera	Inuktun Spectrum 90™ Optional: Inuktun Spectrum 120HD™ high definition camera*
Rear Facing Camera	InuktunSapphire™
Operating Temperature	0 °-50 °C (32 °-122 °F)**
Vehicle Weight	46 kg (102 lb)

Pipe Range	406 mm (16 in) minimum, 914 mm (36 in) maximum***
Standard Components	3 × Inuktun Minitracs™ 1 × Inuktun Spectrum 90™ camera 3 × auxiliary LED lights Tripod chassis and wiring harness 300 m (1,000 ft) tether Rack mount PC-based controller and power supply with ICON™ control and reporting software

*Maximum tether length 300m (1,000ft) with HD video
**Dependent on operating conditions. Ask your sales expert for more information
***Track extensions required for full diameter range



Inuktun VT150 Vertical Crawler™ standard dimensions

Units in inches [mm]

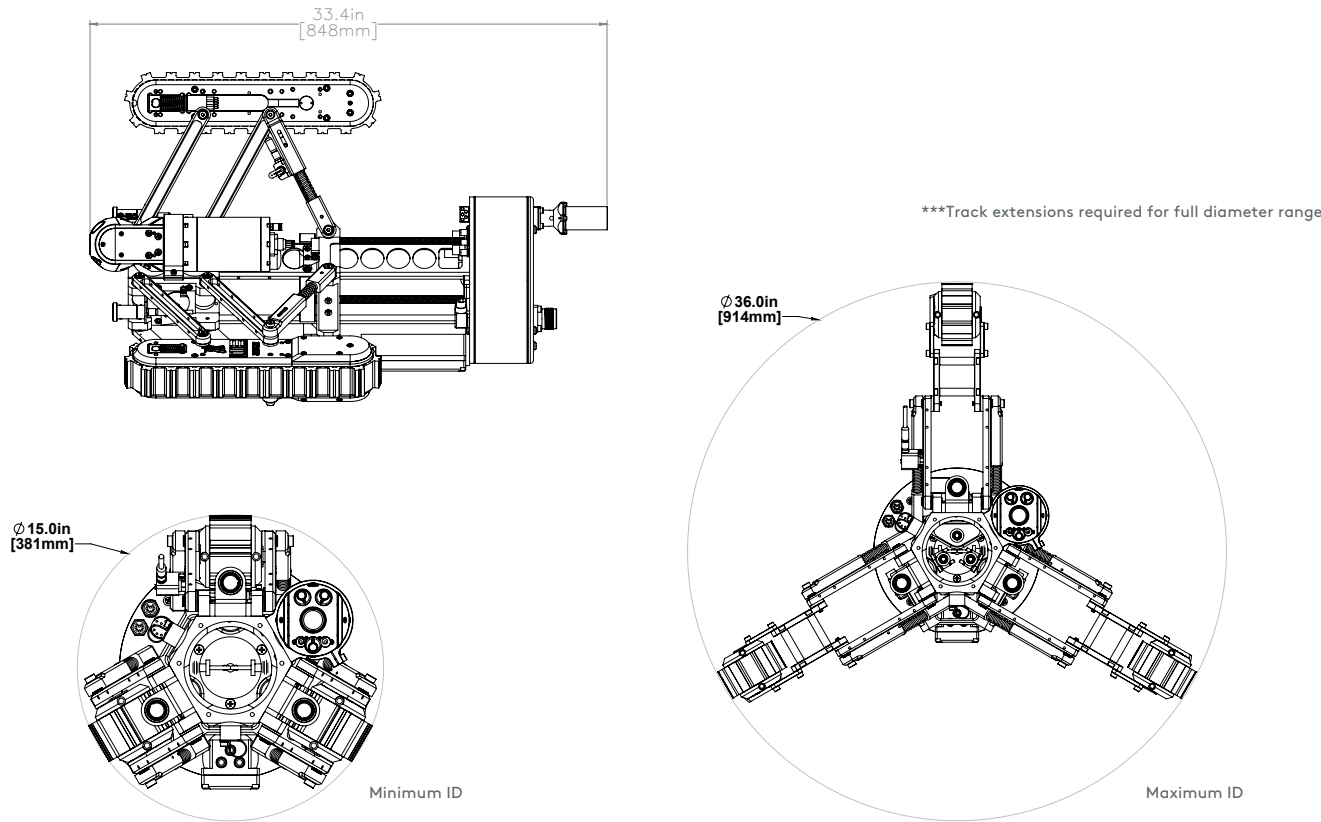

Note that minimum access and minimum operating IDs may differ

The information in this document is accurate as of its publication. Actual products may differ from those presented herein.
© 2019 Eddyfi NDT, Inc. Crystal Cam, IM3, and their associated logos are trademarks or registered trademarks
of Inuktun Services Ltd. (wholly owned subsidiary of Eddyfi NDT, Inc.) in Canada and/or other countries.
Eddyfi Technologies reserves the right to change product offerings and specifications without notice.